



Canal Park



Aquetong Lake at Ingham Spring

Historic "Judy House" at Ingham Spring



Inventory and Analysis

Solebury Township Park and Recreation Facilities

Canal Park

Canal Park is an 11.9-acre site located at 2520 River Road (Route 32) adjacent to the New Hope Lambertville Toll Bridge and the Delaware Canal. The parcel is directly across from Magill's Hill Park, and part of the property lies within rights-of-way for the PECO high-tension electric line and the Spectra Energy gas pipeline. The access entrance from River Road into Canal Park was constructed in 1999.

A grant from the Delaware River Joint Toll Bridge Commission (DRJTBC), funded improvements and connecting trails. Construction was completed in October 2009 and the facility officially opened in the spring of 2010.

Canal Park has one full size multi-purpose playing field used primarily for soccer, a large practice field area, open and wooded areas for passive recreation, walking trails, and the Malcolm P. Crooks pedestrian footbridge which crosses over the Delaware Canal and connects to the Delaware Canal State Park and 60-mile Towpath.

Ingham Spring

Solebury Township purchased the 48.3 acre Ingham Spring property from the Pennsylvania Fish and Boat Commission in 2009. The site is located along US Route 202 and the corner of Lower Mountain Road. Tribes of the Unami Lenape nations were the earliest known inhabitants of the area.

The site is largely wooded and contains Aquetong Lake, a man-made water body that is fed by Ingham Spring, the largest natural spring in southeastern Pennsylvania. The spring is the headwaters of Aquetong Creek, a tributary of the Delaware River. A rock dam, currently in need of repair, forms a crystal-clear pool of water near the source of the spring. Also in need of repair is the large dam at Aquetong Lake. The site contains two houses, including the Historic "Judy House", which are serviced by on-site wells and septic systems. Neither house is presently occupied. One house is accessed from US Route 202, while the "Judy House" is accessed from a driveway off of Lower Mountain Road.

Inventory and Analysis

When developing this site for public use, vehicular access and parking will be challenging. Public access around the water features will be affected by the repair of the existing dams, which is the first priority at the site. The Township is in the process of preparing plans for the park at Ingham Spring that will provide both recreational and educational opportunities, while maintaining the unique, sensitive eco-system and environment, which is currently a habitat for a wide variety of plant and animal life. Preservation of the historic resources such as the “Judy House” is also an important aspect of the overall plan.

Laurel Park

Laurel Park is part of the Township-owned property at 3092 North Sугan Road in Solebury village. The 17-acre park is situated next to the township complex and is accessed from a driveway directly behind the municipal building. A number of active and passive recreation facilities are present, including three baseball fields, a softball field, two tee-ball fields, three batting cages, one soccer field, one football field, and walking trails.

A grant from the PA Department of Conservation and Natural Resources (DCNR) in the amount of \$250,000 along with community donations and Township resources funded substantial improvements to the entire facility, which included walking trails, parking improvements, ADA accessibility, storm water management, and the complete construction of an official Little League baseball field and a multi-purpose intramural soccer field.

A grant from the Bucks County Community Development Block Grant program in the amount of \$44,056, along with community donations and Township resources funded the construction of handicapped accessible bathroom facilities at the existing snack stand building.

All of these improvements were completed by April 2011 and were then opened to the public for use.

The community sports leagues utilize the fields for both practices and games from March through December. None of the playing fields have lights. Laurel Park also features a modern playground designed for children between the ages of 2 and 12. The Township has prepared a master plan for this site and leases a portion of the New Hope-Solebury school district property, via an Intergovernmental Agreement signed in 2006, for parking and for part of the multi-purpose football/soccer field.



Laurel Park Little League Baseball Field



Laurel Park Playground



Laurel Park Snack Stand



Magill's Hill Park

Magill's Hill Park

This 4.9-acre special-purpose park is located at the corner of River Road (Route 32) and Chapel Road. The site consists of a steeply-sloped mowed field that is used extensively for winter activities such as sledding and snowboarding. A PECO high-tension electric power line crosses the site. Limited parking is available and is accessed from Chapel Road. There is a picnic area with tables and benches, but no restroom facilities.

The property was donated to Solebury Township and deed restricted at that time from any additional improvements.

North Pointe Park / Marshall Tract



Winter at Magill's Hill Park

This property is a 30-acre portion of the 104-acre open space area acquired during development of the North Pointe residential community (located on the former Marshall Tract). This 104-acre site is located on the westerly side of Creekside Drive. Pedestrian access and parking to the open space area is provided in designated areas along Creekside Drive. The 30-acre tract that constitutes North Pointe Park was designated for active recreation use to satisfy the developer's parks and recreation requirements.

Silver Tail Lane, the primary roadway within the Fox Run Preserve age-restricted residential development "dead-ends" at the southwest boundary of the park with a gravel, circular turn-around just inside the park property. Ownership of Silver Tail Lane was turned over to Solebury in order to provide access to the park and thereby satisfy the developer's parks and recreation requirements.



Pat Livezey Park Playground

Pat Livezey Park

This 18-acre active recreation park is located along the western boundary of New Hope Borough and provides access to vehicles at two separate locations - Route 202 and Hagan Drive. Due to a significant change in elevation on the property, the park is divided into an Upper and Lower section. A mowed grass pathway provides the

Inventory and Analysis

pedestrian link between the two section of the park, with no vehicular connection.

The Upper Park features a soccer field with spectator seating, a playground for children ages 5 to 12, a walking trail, handicapped accessible restroom facilities and a snack stand. An open-air, stone pavilion provides picnic tables and grills. A stone parking area exists at the end of the entry drive with overflow parking on the grass areas.

The Lower Park features a lighted soccer field and a lighted multi-purpose practice field which was designed to be used as a natural amphitheatre / concert area. A large stone parking area exists at the end of the access from Route 202.

Community sports leagues utilize these fields for both practices and games from March through December.

Solebury Township Trail

This pedestrian walkway and bicycle path is located on the easterly side of Route 202 beginning at Sугan Road next to the Eagle Fire Company building and connects to the New Hope-Solebury School District athletic playing fields, crossing River Road (Route 32), and terminates in Canal Park at the Delaware Canal State Park. The 6 to 10 feet wide asphalt trail follows the right-of-way for the Philadelphia Electric Company's (PECO) high-tension power line. The Township leases the land associated with the trail from PECO for a yearly fee.

Between Sугan Road and the school district property, the trail passes Pat Livezey Park (which is located on the west side of Route 202).

Solebury Park (Roeser Property)

Located along Upper Mountain Road and Street Road, the site contains 80-acres of undeveloped open fields, farmland and woods. The site was designated for future active and passive recreation use by the Township Board of Supervisors. A preliminary "concept plan" was prepared through a series of public meetings, and planning will continue in the future.



Pat Livezey Park Open Air Pavilion



Solebury Township Trail



*Solebury Park (Roeser Tract)
80 Acres of Undeveloped Land*

Solebury Township Park (Roeser Property) Concept Plan

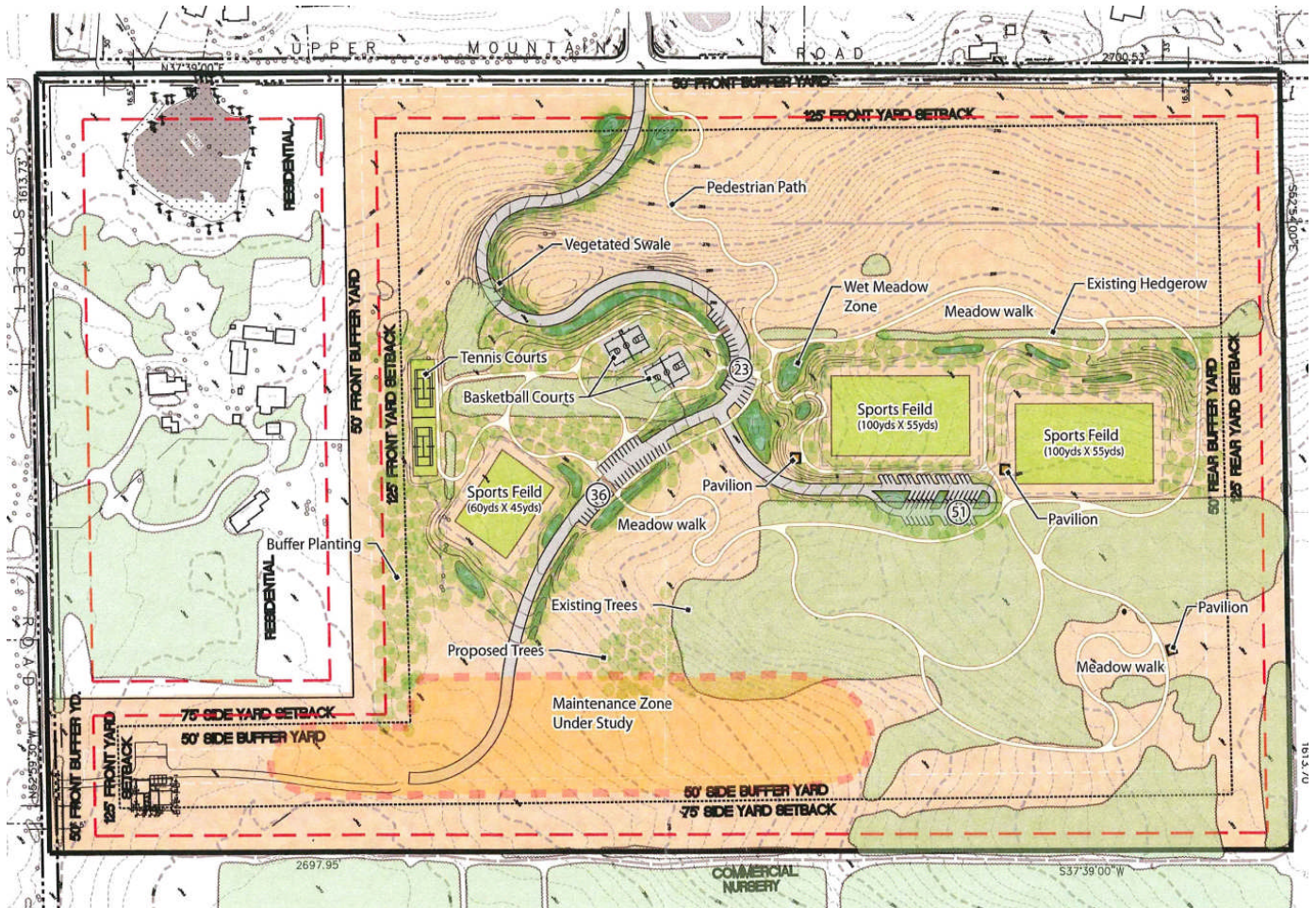

Delaware Canal State Park

Delaware Canal State Park is a linear park that stretches from Easton to Bristol Borough. The park's primary purpose is to preserve the canal and its towpath. To further this goal, the park is designated a National Historic Landmark. Sixty-one acres of the park are located within Solebury Township. Primary recreation activities along the Delaware Canal include walking, hiking and bicycling. The park features a small picnic area at the lock in the village of Lumberville together with a pedestrian footbridge to Bull's Island State Park.

Delaware Canal State Park also contains the Virginia Forrest Recreation Area, which is located on the east side of Route 32 near Laurel Road and features canoe access to the Canal and River, restrooms, a picnic area and ample vehicle parking.



Delaware Canal State Park

Inventory and Analysis

Hal Clark Park

This 27.5-acre parcel is located south of the village of Center Bridge and between the Delaware Canal and Delaware River. The property is owned by Bucks County, and there are no plans to develop the site at this time. A bridge connects the parcel to Route 32.

River Road Tract

This 7.4-acre property owned by Bucks County is located on the west side of Route 32 between Laurel Road and Route 263. The tract is adjacent to the State Game Lands.

PA State Game Lands

Approximately 56-acres of State Game Lands are located on the west side of Route 32 at Laurel Road. The primary purpose of the land is to preserve wildlife habitats. As a result, recreational opportunities are limited to activities such as hiking.

Hendrick Island

Hendrick Island is situated in the Delaware River between Cuttallossa Road and the village of Center Bridge. The Pennsylvania Department of Conservation and Natural Resources acquired the 135.4-acre property as part of a program to preserve islands in the Delaware River. These islands serve as critical “stop-over” points for migratory birds, which use the River as a primary migration route.

Washington Crossing Historic Park

Washington Crossing Historic Park, owned by the Pennsylvania Historical and Museum Commission, is located along the Delaware River at the border of Solebury and Upper Makefield Townships. The park is roughly bisected by Route 32, with 220.5-acres lying within Solebury Township. Special amenities include the Historic Thompson-Neely “House of Decision”, Bowman’s Hill Wildflower Preserve, Bowman’s Hill Tower, and the American Revolutionary Soldiers Gravesite. Hiking trails, restrooms, pavilions / picnic areas and ample parking are available throughout the park. Nature study, historic interpretation and hiking / walking are the most common recreational activities at this site.



*Washington Crossing State Park
Thompson-Neely “House of Decision”*



Bowman’s Hill Wildflower Preserve



Washington Crossing State Park Pavilion



*Honey Hollow
Environmental Education Center*



Track Facility at New Hope-Solebury High School



Honey Hollow Environmental Education Center

This 120-acre property is operated by the Bucks County Audubon Society (BCAS). The center provides year-round environmental education programs for schools and community groups. A variety of trails within the site are available for public use. This facility is located within the Honey Hollow Watershed, which was designated a National Historic Landmark in 1969 for the innovative soil and water conservation practices carried out by property owners. The center is accessible from both Route 263 and Creamery Road.

New Hope-Solebury Lower Elementary School

The Lower Elementary School (grades K, 1, 2) is located on the east side of Sungan Road in the village of Solebury and adjacent to the Township municipal complex. The 8.2-acre site is contiguous with Laurel Park and contains a playground, open grass play areas and a paved playing surface with outdoor basketball nets. The Laurel Park Master Plan proposed connections to the school by a series of boardwalk pathways, as well as a roadway to improve traffic flow and parking, and improvement to the school's multi-purpose field. These improvements have not yet been made.

Solebury School

Solebury School is located on a 90-acre campus at Phillips Mill Road and School Lane. It is a private, coed, boarding and day school for students in grades seven through twelve. In the past, the township has used the tennis courts at Solebury School for tournaments, while the Solebury Basketball program has used the indoor basketball courts. Solebury Soccer program has also used the school's field. Other recreational amenities include an outdoor pool, baseball field, and all weather track and athletic field.

New Hope-Solebury School District Campus Complex located in New Hope Borough

Middle / Upper Elementary / High School Campus

At 180 West Bridge Street (Route 179), the New Hope-Solebury School District (NHSD) operates three adjacent schools on approximately 88-acres. The athletic fields associated with these schools are in close proximity to Solebury Township. In fact, the Solebury Township Trail passes along the school complex and the edge of the

Inventory and Analysis

athletic playing fields. Recreational facilities at the school complex include baseball, field hockey, lacrosse, soccer and football fields, plus outdoor tennis and basketball courts. Solebury cooperated with the school district and community groups to construct an all-weather track facility at the high school. Solebury Township programs and other community organizations make extensive use of the playing fields and facilities by coordinating all schedules and events with the school athletic director and operations department.

Solebury's Summer Adventure Camp is held at the Upper Elementary School in July and August in cooperation with the district's special education department.

Additionally, the Solebury Basketball program uses the three school gyms for all practices and games for both its Intramural and Travel divisions from September to March each season.

NHSD completed a years long study and site analysis in 2010 of its campus and facilities resulting in a phased Master Plan for addressing current and future needs. In 2012 NHSD consultants completed an ADA assessment and proposed a plan to address the immediate and long range items related to handicapped accessibility.

Solebury Township Open Space Descriptions

Cuttalossa Road

The Township owns approximately 34-acres of open space on both sides of the Cuttalossa Creek along the Cuttalossa Road corridor. The landscape along Cuttalossa Road between Sугan Road and Route 32 is best described as a steeply-sloped, densely-wooded stream valley. Use of the property is limited by deed restrictions for natural resource protection.

Laurel Run

This open space area along Laurel Road between Comfort Road and Route 32 is intended to protect the watershed of Laurel Run. This 17.68-acre tract is in close proximity to the State Game lands at Laurel Road and Route 32.

Limeport

The Limeport open space area is a 4.8-acre tract located off of Route 32 between Hal Clark County Park and the village of Phillips Mill. Due to the fact that the Limeport tract is a narrow strip of land between the Delaware Canal and Delaware River, the potential for active recreational use is minimal.

Reeder Road

This 1-acre open space area is on the east side of Reeder Road, between the New Hope-Ivyland Railroad tracks and Stony Hill Road.

Recreation Programs

The Solebury Township Parks and Recreation Department offers a variety of programs for residents including recreation programs and special events. Programs provided by the Parks and Recreation Department are of high quality as recognized by the recent Pennsylvania Recreation and Parks Society (PRPS) awards to Solebury Township for Excellence in Programming. Each year, the PRPS examines the programs of all agencies throughout the State and selects winners for Excellence in Programming in 13 categories. Since 2004, Solebury Township Parks and Recreation has received five awards from PRPS.

Solebury Parks and Recreation received its first award in the category of Health, Fitness and Wellness for its Adult CPR-AED Training Program. This unique and innovative community outreach program provides training in basic life saving through the use of cardiopulmonary resuscitation (CPR) and the use of Automated External Defibrillators (AEDs). The second award was in the category of community public and/or private partnerships for Parks and Recreation's support and partnership with Track 2002 (the track facility located at New Hope-Solebury High School). Over a four year period, the Solebury Township Parks and Recreation Department financially supported the effort with more than \$10,000 in sponsorships for race events, dinner dances, summer running programs, and advertising. In addition, capital funds in the amount of \$45,000 were committed to the project.

Solebury Parks and Recreation was selected as a winner in the category of community festivals and events for its work and participation in the community's annual New Hope-Lambertville Winter Festival. As the result of its participation in this event each year, Parks and Recreation received a total of \$45,500 from the Winter Festival Committee.

Solebury Parks and Recreation was again selected as a winner in the category of Health, Fitness and Wellness. This time, the award was for its Summer Adventure Fitness Camp. This camp was restructured in 2005 to take a leadership role in the area of health, fitness and wellness. Part of the restructuring involved applying initiatives set forth by the National Recreation and Park Association. In 2011 the Camp program became located at the New Hope -Solebury Upper Elementary school campus in order to provide opportunities to the extended school year (ESY) program for children with special needs.

Most recently in 2011, the Excellence in Programming for unique advertising was awarded to Solebury for its interactive Winter Festival placement used in local restaurants.

Solebury Parks and Recreation programs are offered through certified instructors and volunteers. Program fees are determined and set by the Township in an effort to allow the program to be self-sufficient. Many factors are considered when determining program fees including instructor salaries for programs such as the Summer Adventure Camp, equipment needs, supply needs, facility rental fees, township staff salaries, and advertisement fees. External considerations are also made in regards to whether a program is offered elsewhere and if so what is a comparable registration fee. Without careful fee consideration, programs may not sustain enough registration in order to run the program. Most Solebury Township Parks and Recreation Department programs are self supportive, however, certain programs, such as the Township's CPR training, are run for the benefit of the community at no cost to residents or taxpayers.

Solebury Township partners with youth sport groups to offer youth baseball, basketball, soccer, wrestling and football programs. Administration of these sports programs are

Inventory and Analysis

provided by a varied combination of Township staff and the youth sport group's volunteer efforts with the youth groups determining their own registration fees. The current structure and working relationship of the Township and the youth sport organizations is unique to this community. The Director of Parks and Recreation sits on several youth sports boards, attends their meetings, and purchases equipment through the Township's tax exempt status. The Director of Parks and Recreation administers online registrations for some of the sports groups and coordinates the use of Township fields and facilities among the sports groups.

Special events play an important role in Solebury Township's recreational program offerings as well. Annual events available to Solebury Township families include special programs such as an Easter Egg Hunt, a Halloween /Community Safety Night event., and a partnership and sponsorship of the New Hope Automobile Show and Road Rally. These events are funded by the Township and made possible through the hard work of the volunteers and the Parks and Recreation Director.

In addition to Parks and Recreation Department programs, residents have recreational programs available to them through a variety of public and private agencies located in Solebury Township, New Hope Borough, and the surrounding communities.

Private Recreational Facilities (including distance from Solebury)

Athletic and Fitness Clubs

- Body Tech Fitness: 80 Lambert Lane, Lambertville (4 miles)
- Cornerstone Health & Fitness: 419 York Road, New Hope (3 miles)
- Cornerstone Health & Fitness: 740 Edison – Furlong Road, Furlong (6 miles)
- Central Bucks YMCA: 2500 Lower State Road, Doylestown (8 miles)
- Hunterdon County YMCA: 144 W. Woodschurch Road, Flemington (20 miles)
- New Hope Fitness: 510 Union Square, New Hope (4 miles)
- Newtown Athletic Club: 209 Penns Trail, Newtown (16 miles)
- The Solebury Club: 4612 Hughesian Drive, Buckingham (5 miles)

Tennis

- Buckingham Racquet Club – Mechanicsville Rd., Doylestown (4 miles)
- Doylestown Tennis Club - 10 Welden Drive, Doylestown (9 miles)

Tubing, Rafting, Canoeing

- Bucks County River Country – 2 Walters Lane, Point Pleasant (9 miles)

Golf

- Makefield Highlands – 1418 Woodside Road, Yardley (13 miles)
- Heron Glen Golf Course – 110 US Highway 202, Ringoes, NJ (14 miles)
- Lookaway Golf Club – Upper Mountain Road, Buckingham (5 miles)
- Jericho National Golf Club – 250 Brownsburg Road, Upper Makefield (8 miles)
- Hillsborough Country Club – 146 Wertsville Rd, Hillsborough, NJ (18 miles)
- Bucks County Country Club – 2600 York Rd, Jamison (13 miles)

Bucks County, Pennsylvania

Partnerships

Solebury Township's strongest partnerships are with local youth sports programs and local community organizations (i.e. the New Hope-Solebury Community Association). The Parks and Recreation program assists in the administration and operation of local youth sports programs including baseball, basketball, soccer, wrestling and football. This partnership has greatly benefited both the Township and these youth sports programs.

At Laurel Park, for example, the Township benefited from the multi-purpose field built by the Soccer Club many years ago. Additionally, the snack stand building at Laurel Park was constructed with funds from the Baseball League. The baseball, soccer and football sports organizations provided about 20% of the funding for the handicapped accessible restroom facilities. At Pat Livezey Park, the Soccer Club funded the installation of field lighting at the lower field along U.S Route 202 and continues to pay for the electric service. In addition to facility construction, the Township benefits from the field maintenance support that the youth sports programs provide.

The Basketball organization provided more than \$22,000 in funding to install four electric operated baskets at the new gymnasium built at the New Hope-Solebury upper elementary school campus. The gym is used by the Township's intramural and travel basketball teams for team practices and games.

The youth sports programs benefit from their partnership with the Township in a number of ways. Scheduling of games and facility use is administered by the Township, as well as program registration. The leagues also benefit from insurance liability coverage from the Township, coach background checks performed by the Township, and by having league finances maintained in Township-designated fund accounts. Leagues may also order equipment and supplies through the Township's tax-exempt status.

Other important partnerships exists with the New Hope-Solebury School District (NHSSD) and Solebury Private School. NHSSD allows the use of many of its facilities for Parks and Recreation programs, including various school gymnasiums and the athletic fields on the high school complex. Solebury Parks was involved in the New Hope- Solebury Community Association Track 2002 Committee, a multi-year partnership that resulted in the construction of a new track and sports field facility at New Hope-Solebury High School.

Solebury School also provides use of its gym facilities and fields.



Inventory and Analysis

Maintenance

Solebury Township has a park and facility maintenance program in place that combines contracted services, user maintenance, and township maintenance to provide high quality, well maintained park facilities for residents.

Lawn cutting service, for example, is outsourced through a bid process with contract specifications prepared by the Township. Youth sports groups prepare fields for games and practices (i.e. field lining and infield raking, set-up of bases and portable goals) while Solebury Township contracts standard park maintenance services such as trash removal. Should field conditions warrant, such as fields being too wet to use, the Township makes field closing decisions. The youth sports organizations are aware of the Township's philosophy and policy on field use so decisions to cancel games and/or practices have worked well in the past and are coordinated with those organizations.

Finances

Funding for the Parks and Recreation Department is provided through a variety of sources. Programs are self-funded and any profits are used within those programs as well as to fund a variety of free programs, such as the annual Easter egg hunt and the Halloween Community Safety Night.

Funds are also raised by the sale of Parks and Recreation limited edition tiles that depict various aspects of Solebury, and by the sale of a Solebury front license plates for vehicles.

Community volunteers, together with members of the Parks and Recreation Board also participate in other fund-raising projects during the year such as the Lambertville-New Hope Winter Festival. To date, the volunteers have raised \$45,500 from the Winter Festival, and those monies have been deposited in the Township's General Fund for future recreation use.

The Township's General Fund pays for normal expenses similar to other departments, such as salaries, maintenance of facilities and administrative expenses.

Builder fees for new construction are deposited to the Park Capital improvement fund. This fee is currently set by the Board of Supervisors at \$4,000 per dwelling unit or per 4,000 sq ft of non-residential construction.

Facility use fees offset expenses for maintenance and other costs associated with reserved use of fields and facilities by groups and organizations and deposited into the General Fund.

When comparing Solebury Township to other communities, it is evident that most local municipalities finance parks and recreation with tax-supported budgets from a direct millage assessed for parks and recreation. This is not the case in Solebury Township. Instead, all funds necessary to operate the Parks and Recreation Department and its programs come from the Township's General Fund, donations, revenue generated by programs offered, fund raising activities, and through income from youth sport partnership organizations.

As Park and Recreation Department revenue is received, money is deposited into a pooled cash account know as the General Fund . At the conclusion of the fiscal year, the Solebury Township Parks and Recreation Department retains remaining funds for the following year's budget.